



A600

All you need for
perfect coffee

FOAMMASTER™

MAKE IT
Wonderful!

FRANKE

Mon 12:11
Nov 14th

FRANKE



Espresso



Ristretto



Espresso Macchiato



Brewed Coffee



Cappuccino



Cinnamon Cappuccino



Vanilla Cappuccino



Latte Macchiato



Vanilla
Latte Macchiato



Milky Coffee



Chocolate



Tea

Inspire me



Quick Select

FRANKE

INTELLIGENT AND USER FRIENDLY

As a truly intelligent coffee machine, the A600 redefines how you interact with it.

- Intuitive overview for self-service operation
- Inspiring impressions of enjoyment
- Efficient support in service
- Functional lighting concept for total control



THE DETAILS MAKE THE DIFFERENCE

Selection from three **different brewing units** – optimally adjusted to your way of making coffee

The intuitive touchscreen makes operation simple and efficient, and **can be configured to your individual requirements**

Functional **lighting concept**

Generously sized bean hopper for simple refilling (2 × 1.2 or 2 kg)

Maximum energy efficiency thanks to a **timer function** and minimal power consumption in Standby mode



INNOVATIVE SWISS TECHNOLOGY FOR PERFECT COFFEE ENJOYMENT

When it comes to **making coffee**, the core process is and always will be **extraction**.

- The new A600 optimizes this process and ensures **perfect results in every cup**
- To create a perfectly **matched system**
- The practical, **easily accessible bean hopper**
- **The central unlocking mechanism on the front of the machine**
- **Direct access to the coarseness settings** in the ceramic grinder – and all without the use of any tools
- Can also be replaced easily without any tools
- For predominately single cups of specialty coffees and for **a perfect espresso**: 43mm brewing unit
- For predominately **two cups at once and for large cups**: 50 mm brewing unit
- For predominately **brewed coffee** and single cups of classic coffee: **patented needle filter**

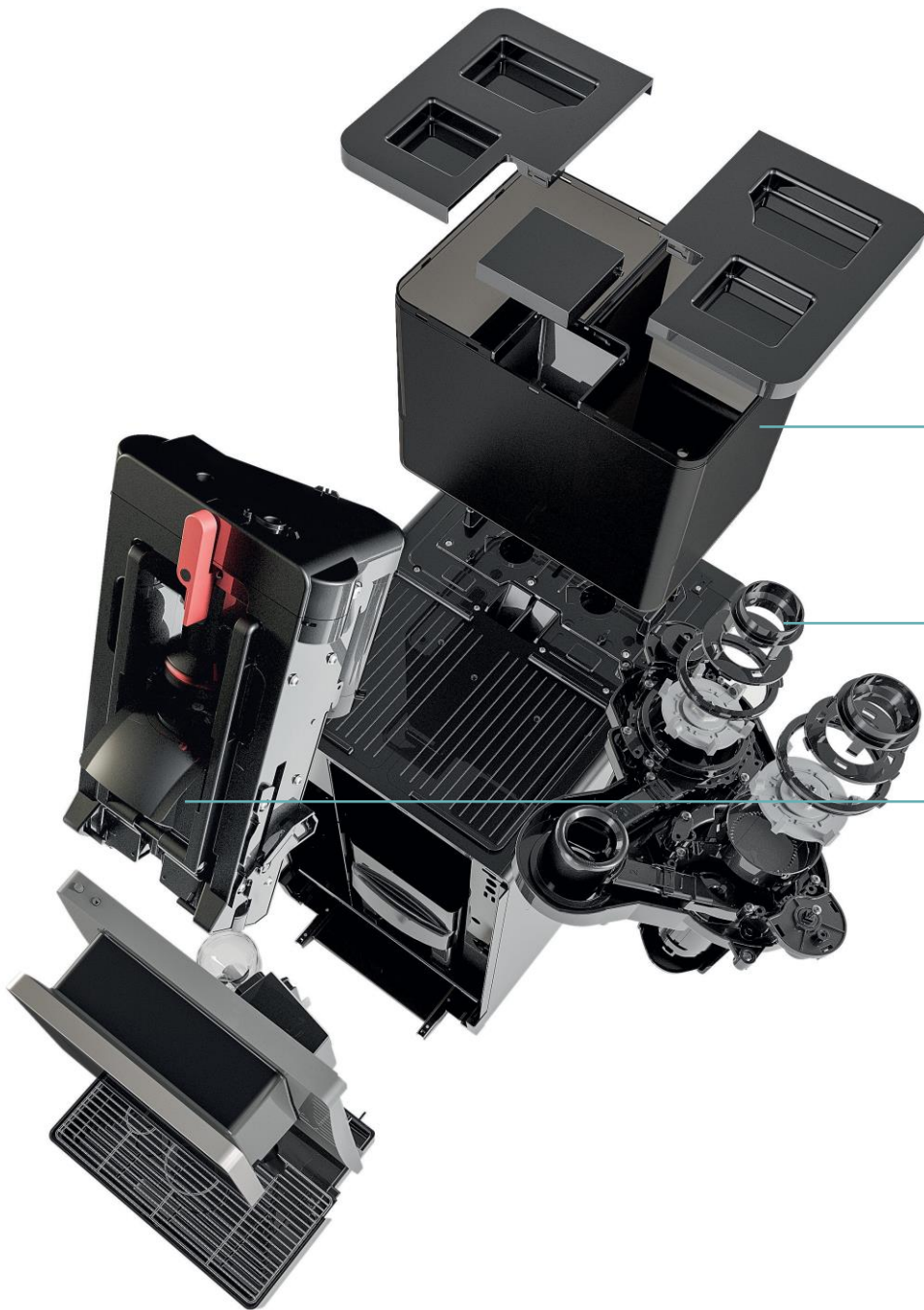

Bean hopper

Precision bean grinder with
long-life **ceramic burrs**

Patented **brewing unit**,
removable from the front

SIMPLE HANDLING FOR MAXIMUM HYGIENE

FoamMaster™: With this advanced milk system, you can set the foam consistency for specific beverages.

- A new standard of **convenience**
- **Integrated cleaning concept**
- Hygienic, **practical milk container system**
- **Hose-free docking system** for the milk container
- **Automated process** with integrated cleaning cartridge
- **Maximum convenience:** the cleaning process is ended automatically by the machine
- **Conforms to HACCP**

Milk container (5 liter) with integrated **temperature sensor** and docking system



Cleaning container with integrated **docking system**



The cleaning agent cartridge



ONLY PERFECTION IS GOOD ENOUGH

Our highest priority is **the perfect beverage** and thus satisfied customers. You will be thrilled with the consummate taste experience.

- Endless possibilities with hot and cold milk, **hot and cold milk foam** and flavors
- All products from the world of **coffee**, and all with **a quality, authenticity and precision that will excite any coffee lover**
- **Two different chocolates** and enables the preparation of all types of chocolate specialties
- You can enhance your beverages with up to three different **flavored syrups**

AS INDIVIDUAL AS YOU

MILK SYSTEMS

- FoamMaster™ (FM)*: hot and cold milk and milk foam, individually adjustable consistency, integrated cleaning system
- Milk system (MS): hot milk/milk foam, exact dosing via milk pump

A600 OPTIONS

- Second bean grinder
- 2 × 2 kg bean hopper, lockable
- One or two separate powder dosing systems (for chocolate or milk powder, lockable)
- Coffee grounds ejector
- Cup sensor
- M2M/telemetry
- Billing systems
- Raised feet (100 mm)
- Autosteam steam spout (enhanced milk foaming) or Autosteam Pro (automatic milk foaming)

FLAVOR-STATION

Automatic dosing station for up to three flavors

CUP WARMER

With four heatable trays



A600 – NEW FEATURES COMPARED TO EVOLUTION/PURA

The perfect coffee

- Limitless beverage options with a flavor station, 2 separate powder dispensers and a powder inserting slot
- Use of precision ceramic grinding discs
- 3 different brewers depending on the field of application in order to produce the perfect coffee (43-er ideal for espresso, 50-er for higher volumes, patented needle filter for breakfast coffee without cream)
- Gentle and optimized storage of the coffee beans, no heating from the grinder, optimized slipping of the bean in the bean hopper

A600 – NEW FEATURES COMPARED TO EVOLUTION/PURA

Ease of use

- Intuitive touch screen with specific operating modes e. g. for self-service, pre-order function for QSR or display of videos
- Products are independently and individually adjustable by the customer (no technician needed)
- Simple grinding degree setting
- Easy to fill and clean the bean hopper thanks to a unique unlocking device (1 bean hopper for 2 grinders)
- Functional lighting concept, corresponding with program message on the touch screen. Red: staff knows that something has to be done. Illuminated beverage outlet: warning towards customer that a process is in motion

A600 – NEW FEATURES COMPARED TO EVOLUTION/PURA

Increased efficiency

- Optimized use of energy, reduced electricity consumption on standby, on-off-switch, zero-energy, timer-function for optimized connection time, on-off-hours per day configurable, automated changeover from summertime to wintertime
- Heated cup storage with waste heat

Simplified cleaning and maintenance

- Automated, menu guided cleaning process, around 2-minutes cleaning effort, thereafter around 10-minutes full-automated cleaning process (no staff needed)
- Front access to all relevant compounds (water tank, instant mixer, brewer etc.)
- Basic maintenance through customer
- Rapid and easy exchange of brewer without tools thanks to a click mechanism

A600 – NEW FEATURES COMPARED TO EVOLUTION/PURA

Increased flexibility

- Machine is thanks to various add-ons adaptable to customer requirements
- Add-ons easily combinable
- Flexible water supply (4l water tank or permanent water connection), permanent water connection easy to retrofit
- Height adjustable, illuminated beverage outlet